

Type C, C/2, C/3 Vertical Female DIN

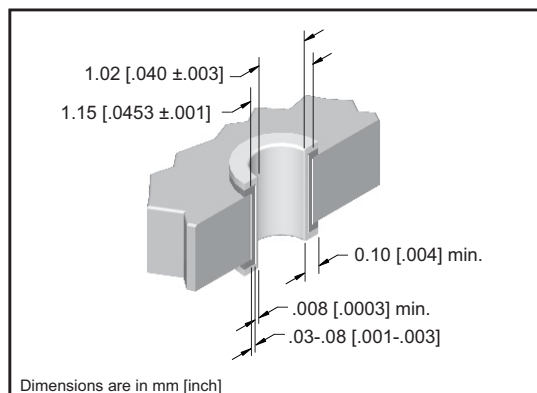

DIN 41612 SPECIFICATION

Temperature Range	-55°C to +125°C	
Insulator Material	PBT 30% Glass Filled UL 94 V-0 Rated	
Contact Material:	Copper Alloy	
Contact Plating / Performance	Level 1	≥ 500 Mating Cycles
	Level 2	≥ 400 Mating Cycles
Per DIN 41612	Level 3	≥ 50 Mating Cycles
Contact Resistance	≤ 20m Ω	
Insulation Resistance	≥ 10 ¹² m Ω at 100 VDC	
Dielectric Strength	≤ 1000 VDC	
Current Range at Ambient Temp. Of	+20C	3.0 Amp
	+70C	2.0 Amp
	+100C	1.0 Amp
Insertion Force (N)	20 contacts @ ≤18 48 contacts @ ≤45 30 contacts @ ≤28 64 contacts @ ≤60 32 contacts @ ≤30 96 contacts @ ≤90	
Withdrawal Forces Per Contact (N)	> .15	



DRILLED HOLE DIAMETER	PLATING THICKNESS	HOLE DIAMETER	PAD DIAMETER	INSERTION FORCE PER PIN	WITHDRAWAL FORCE PER PIN
1.15 [.0453]	Copper	After Plating .040±.003	1.65 [.065]	40 lbs. Max.	10 lbs. Min.
	Tin .008 [.0003]min.				

APPROVALS



Recognized under the recognized component Program of Underwriters Laboratories, Inc.
File Numbers: E176234

IEC 60603-2 Standard

Bellcore GR 1217 CORE

Connectors are available that meet the requirements of Bellcore GR 1217-CORE. Please consult factory for ordering information.

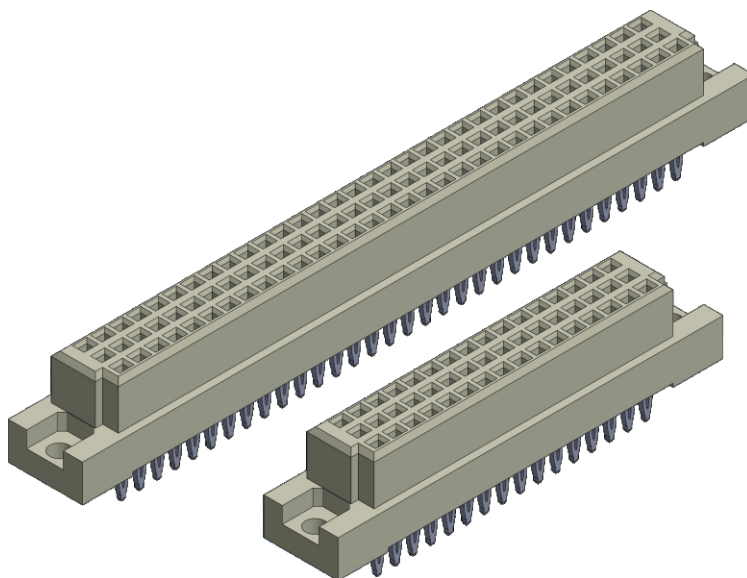

Type C, C/2, C/3 Vertical Female DIN



Type C (96 Positions), C Extended (120 and 150 Positions)

Dim.	96 Positions	120 Positions	150 Positions
A	78.74 [3.100]	99.06 [3.900]	124.46 [4.900]
B	85.00 [3.347]	105.33 [4.147]	130.73 [5.147]
C	90.00 [3.543]	110.31 [4.343]	135.71 [5.343]
D	95.00 [3.740]	115.32 [4.540]	140.72 [5.540]

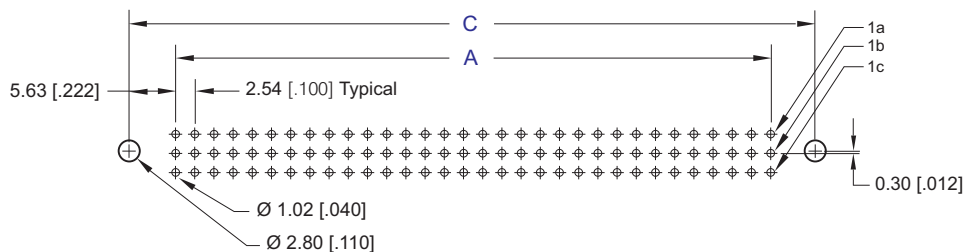
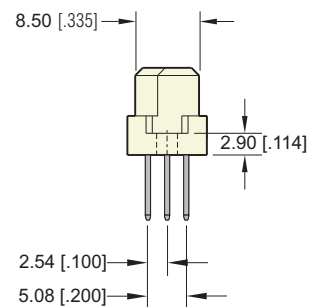
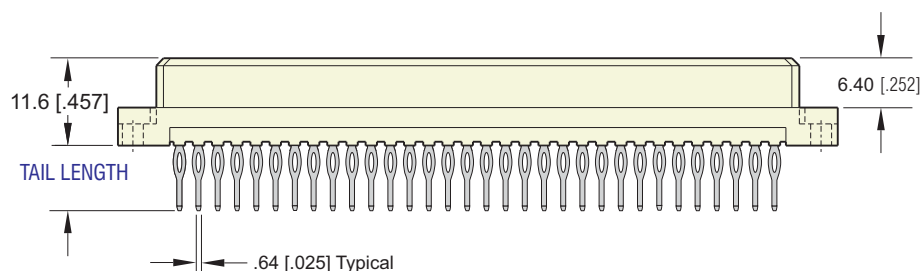
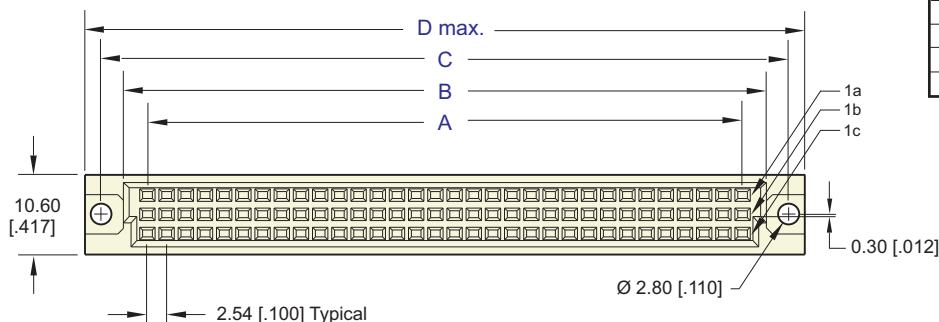

Recommended P. C. Board Layout

TAIL LENGTH OPTIONS

Press Fit				Solder and Wire Wrap		
1	2	3	4	5	6	7

Type C, C/2, C/3 Vertical Female DIN



Type C/2, 48 Positions

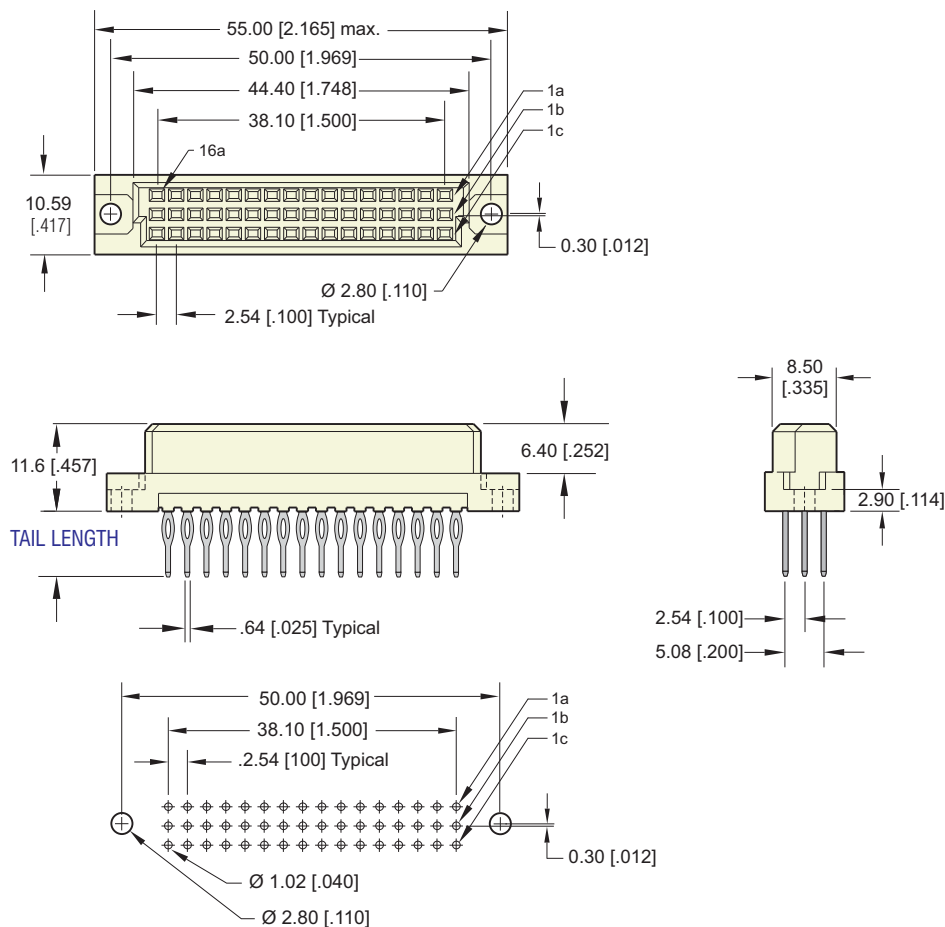

Recommended P. C. Board Layout

PART NUMBERING

SERIES CODE

DIN 41612 Type C, C/2 and C Extended Female

BODY STYLE

- 0 = C/3 (30 positions) not shown
- 1 = C/2 (48 positions)
- 2 = C (96 positions)
- 3 = C Extended (150 positions)
- 4 = C Extended (120 positions)

NUMBER OF CONTACTS

- 0 = 30
- 1 = 16
- 2 = 32
- 3 = 48
- 4 = 64
- 5 = 96
- 6 = 150
- 7 = 120

CONTACT LOADING

- 1 = Row A, B, and C fully populated
 - 2 = Row A and B fully populated, Row C not populated
 - 3 = Row A and C fully populated, Row B not populated
 - 4 = Row B and C fully populated, Row A not populated
- Consult Factory for other Loading Options

MC = Mounting Clips
Blank = No Mounting Clips

TAIL PLATING

- 1 = Tin
- 2 = Gold flash (.200" from pin tip)
- 3 = Gold plate 30µ" (.200" from pin tip)
- 4 = Gold plate 15µ" (.200" from pin tip)

MATING AREA PLATING

- 1 = Class 1
- 2 = Class 2
- 3 = Class 3

TAIL LENGTH

- 0 = 4.00 [.157] Press-Fit
- 1 = 5.00 [.197] Press-Fit
- 2 = 13.00 [.512] Press-Fit
- 3 = 6.00 [.236] Press-Fit
- 4 = 17.00 [.669] Press-Fit
- 5 = 2.92 [.115] Dip Solder
- 6 = 4.06 [.160] Dip Solder
- 7 = 13.00 [.512] Dip Solder Wire Wrap