

2.0mm FutureBus 4 Row Male Vertical Mono Block



Contact	Dim A	Dim B
024	11.95	10.00
048	23.95	22.00
072	35.95	34.00
096	47.95	46.00
120	59.95	58.00
144	71.95	70.00
168	83.95	82.00
192	95.95	94.00

Specifications

1. Insulator Material: High Temperature Thermoplastic
Glass Filled 94V-O, UL Recognized, color black.
2. Contact Material: Phosphor Bronze
3. Contact Plating: Class 1: 1000 cycles or Class 2: 500 cycles
4. Mating Insertion Force: 0.45N (0.10 lbs) max. per contact
5. Unmating Withdrawal Force: 0.20N (0.045 lbs) min. per contact
6. Compliant Insertion Force: 100N (22.50 lbs) max. per contact
7. Compliant Withdrawal Force: 20N (4.50 lbs) min. per contact
8. Insulation Resistance: 1000 M ohms min. @ 500v
9. Contact Resistance: 30 m ohms max. @ DC 100mA
11. Current Rating: 1 Amp @ 20°C per contact
12. Operating Temperature: -55°C To +225°C
13. UL File Numbers: E 176234, IEEE 896.10 FutureBus+

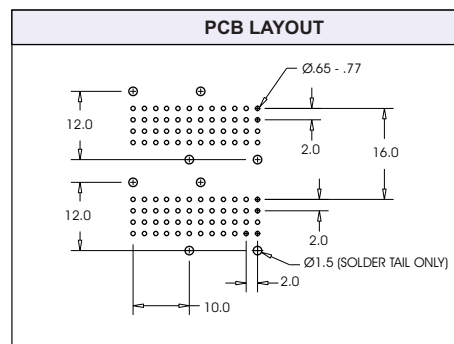
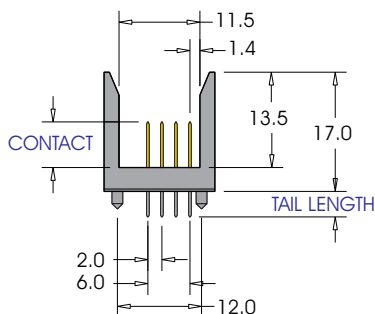
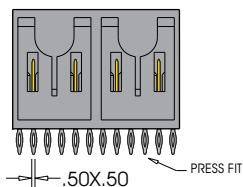
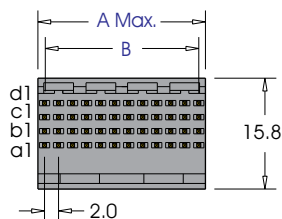
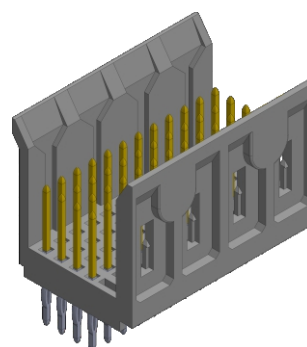

PART NUMBERING

74 — XXX — 4 X XXX — XX — 050

SERIES CODE

NO. OF CONTACTS

SEE TABLE

TERMINATION METHOD

1 = PRESS FIT

2 = DIP SOLDER (picture not shown)

CONTACT PLATING

35 = CLASS 2, 500 CYCLES

55 = CLASS 1, 1000 CYCLES

CONTACT LOADING

P/N CODE	001	002	003	101	102	103	201	202	203	301	302	303	401	402	403
TERMINATION*	PF/DS	PF	PF	PF/DS	PF	PF	PF/DS	PF	PF	PF/DS	PF	PF	PF/DS	PF	PF
CONTACT	5.0mm	5.0mm	5.0mm	5.75mm	5.75mm	5.75mm	6.5mm	6.5mm	6.5mm	7.25mm	7.25mm	7.25mm	8.0mm	8.0mm	8.0mm
TAIL LENGTH	5.0mm	13.6mm	17.0mm	5.0mm	13.6mm	17.0mm	5.0mm	13.6mm	17.0mm	5.0mm	13.6mm	17.0mm	5.0mm	13.6mm	17.0mm

*PF = PRESS FIT
DS = DIP SOLDER

FOR CUSTOM LOADED CONNECTORS PLEASE USE THIS CUSTOMER REQUEST FORM

2.0mm FutureBus 4 Row Male Vertical Mono Block

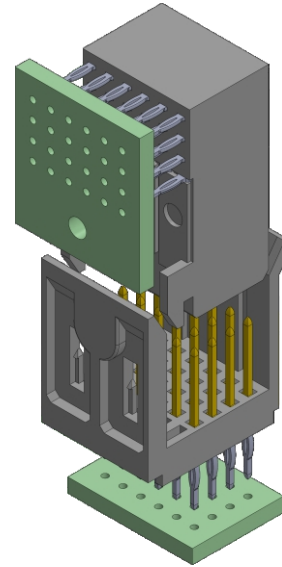
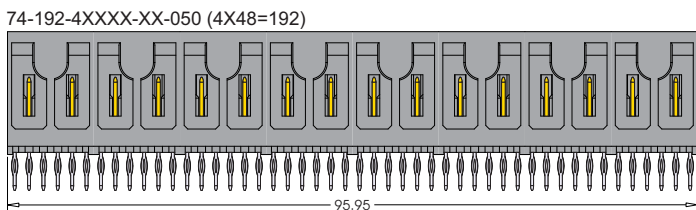
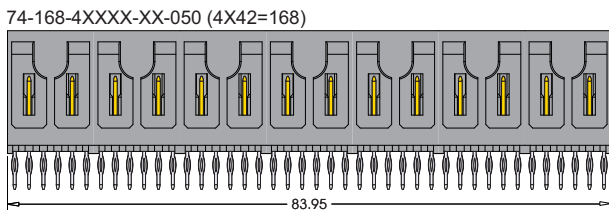
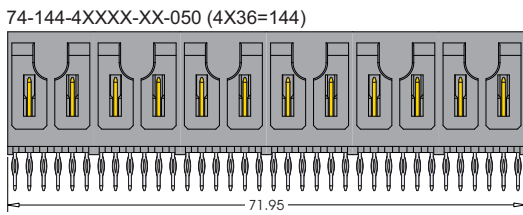
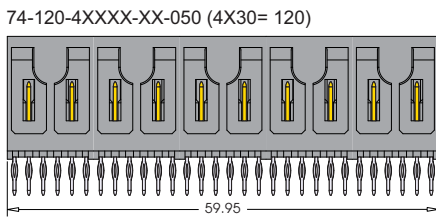
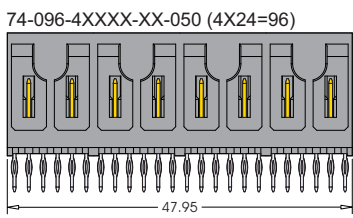
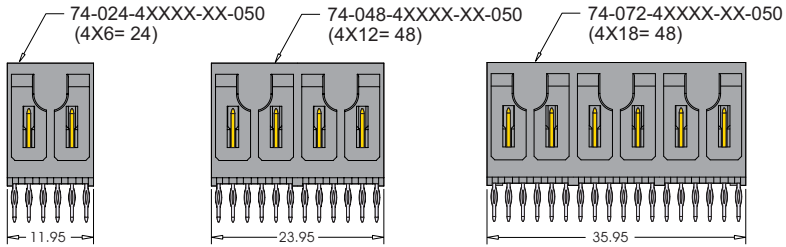
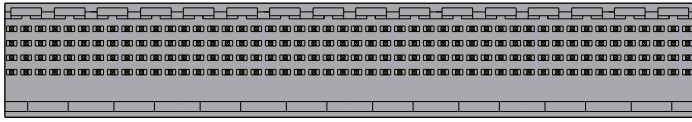

UNMATING WITHDRAWAL:
0.20 N MIN./ CONTACT

MATING INSERTION FORCE:
0.45 N MAX./ CONTACT

PRESS-FIT WITHDRAWAL
20 N MIN./ CONTACT

PRESS-FIT INSERTION FORCE:
100 N MAX./ CONTACT