



3500 Series Card Edge Connector

.156" X .188" Contact Spacing

Specifications

Insulator Material: Glass filled polyester, type PBT, 94 V-O, UL Rated.

Contact Material: Phosphor Bronze Alloy

Contact Plating: Gold and/or Tin over .000050" Nickel, (See Contact Plating Options).

Current Rating: 5 amp at 30°C

Contact Resistance:
 Contact to Daughter Card:
 10 m Ω max.

Insulation Resistance:
 5000 M Ω min.

Dielectric Withstand Voltage:
 1800 V AC

Daughter Board Insertion Force:
 16 oz max. per contact pair when tested with a .071" thick gage.

Daughter Board Withdrawal Force:
 1 oz min. per contact pair when tested with a .054" thick gage.

Operating Temperature:
 -54°C to +125°C

Features

- Extra large chamfered entry
- Conforms to Bell-core spec TR-TSY-00078
- Extended card scoops available
- Replaceable contacts
- Molded in polarization available between contact, or on contact position.
- De-population of contacts per customer specification.
- Available in selective gold plate at contact point
- Many other custom options available, including, but not limited to:
 - Single or Both Ends Open
 - Shorting Contacts

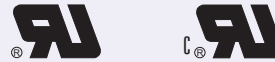

Recognized under the recognized component Program of Underwriters Laboratories, Inc. File Numbers: E146967 and E176234

POS. / CONTACTS	A	B	C	D	E	F
06/12	1.844 [46.84]	1.532 [38.91]	1.263 [32.08]	1.100 [27.94]	0.780 [19.81]	0.996 [25.30]
10/20	2.468 [62.69]	2.158 [54.81]	1.877 [47.67]	1.724 [43.79]	1.404 [35.66]	1.620 [41.15]
15/30	3.248 [82.50]	2.938 [74.63]	2.667 [67.74]	2.504 [63.60]	2.184 [55.47]	2.400 [60.96]
18/36	3.716 [94.39]	3.406 [86.51]	3.135 [79.63]	2.972 [75.49]	2.652 [67.36]	2.868 [72.85]
22/44	4.340 [110.24]	4.030 [102.36]	3.759 [95.48]	3.596 [91.34]	3.276 [83.21]	3.492 [88.70]
28/56	5.276 [134.01]	4.968 [126.19]	4.695 [119.25]	4.532 [115.11]	4.212 [106.99]	4.428 [112.47]
30/60	5.588 [141.94]	5.278 [134.06]	5.007 [127.18]	4.844 [123.04]	4.524 [114.91]	4.740 [120.40]
40/80	7.148 [181.56]	6.830 [173.48]	6.567 [166.80]	6.404 [162.66]	6.084 [154.53]	6.300 [160.02]
43/86	7.616 [193.45]	7.306 [185.57]	7.035 [178.69]	6.872 [174.55]	6.552 [166.43]	6.768 [171.91]

For reference only, can go 1 through 43 positions.

Dimensions are in inch [mm]

MOUNTING STYLE

1= Clearance Hole	2 = #4-40 Threaded Insert	3 = Flush Mount	4 = #4-40 / Flush Mount	5 = No Mounting Ear	6 = Floating Bushing

.156" x .188" Contact Spacing, .045 [1.14] sq. Contact

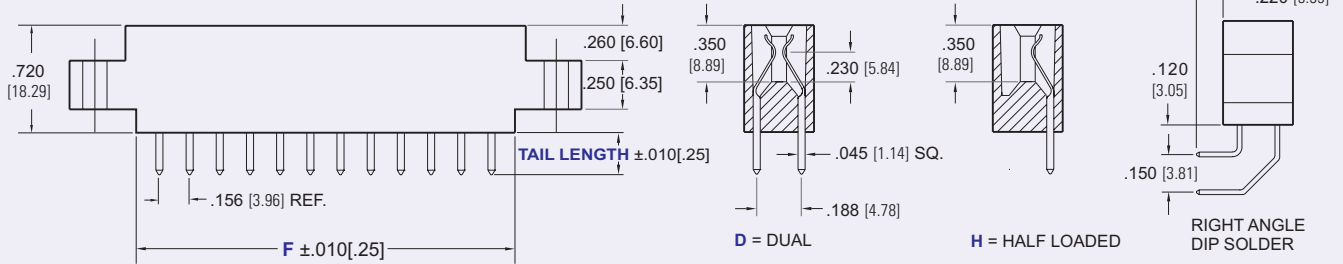
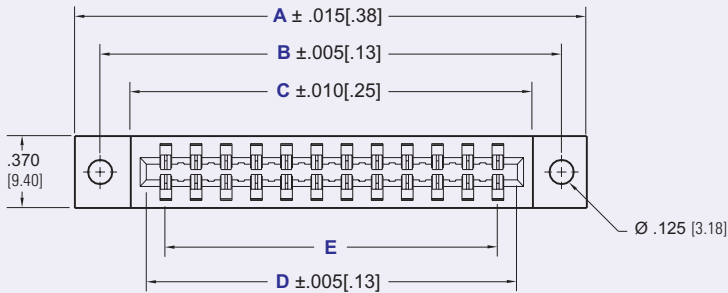
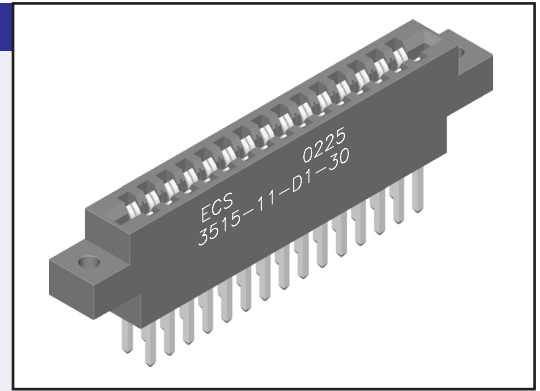

Dimensions are in inch [mm]

PART NUMBERING

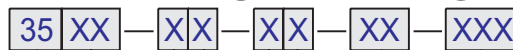

SERIES CODE
 .156 X .188 DIP Solder / Wire Wrap

NO. CONTACT PAIRS
 01 - 43

TERMINATION TYPE
 1 = Straight @ .045 SQ.
 2 = Right Angle @ .045 SQ.

BODY STYLE
 1 = Clearance Hole
 2 = #4-40 Threaded Insert
 3 = Flush Mount
 4 = Flush Mount / #4-40 Threaded Insert
 5 = No Mounting Ears
 6 = Floating Bushing

CUSTOM VARIATION
 CONSULT FACTORY

TAIL LENGTH
 1 = .250 [6.35] Dip Solder
 2 = .570 [14.48] Dip Solder
 3 = .750 [19.05] Dip Solder
 4 = .220 [5.59] Right Angle

READOUT
 D = Dual
 H = Half Loaded

PLATING
 50µ" Nickel Underplate

CONTACT	TAIL
10 = 10µ" Au	100µ" Sn
20 = 15µ" Au	100µ" Sn
30 = 30µ" Au	100µ" Sn
40 = 10µ" Au	5µ" Au
50 = 15µ" Au	5µ" Au
60 = 30µ" Au	5µ" Au

CONSULT FACTORY FOR CONNECTORS BUILT TO YOUR SPECIFICATION