

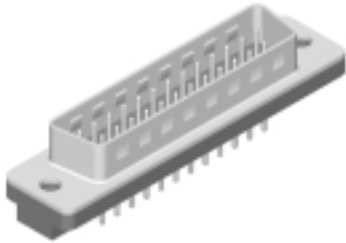

8000 Series D-Subminiature Straight Dip Solder Without Rear Shell

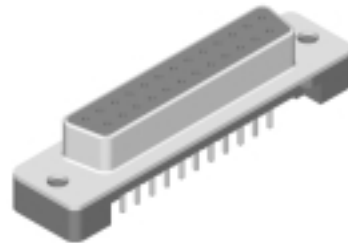

PLUG



RECEPTACLE

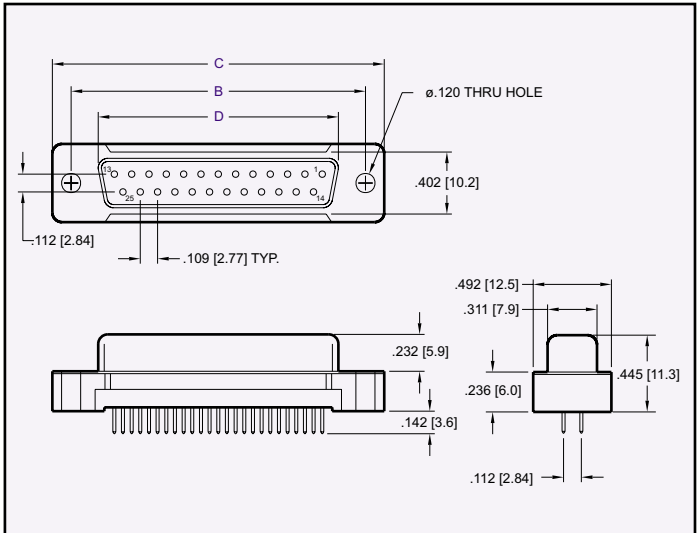
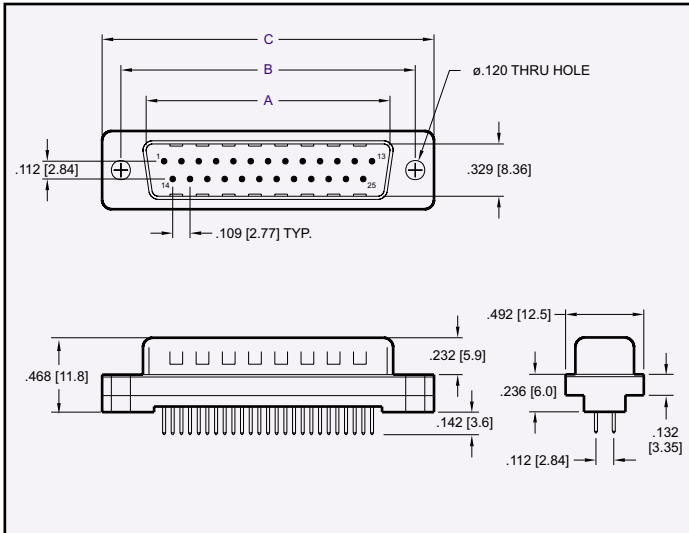

NO. OF CONTACTS	A	B	C	D
09	0.666 [16.92]	0.984 [25.00]	1.213 [30.81]	0.642 [16.33]
15	1.004 [25.50]	1.312 [33.32]	1.541 [39.14]	0.969 [24.66]
25	1.534 [38.96]	1.852 [47.04]	2.088 [53.04]	1.508 [38.38]
37	2.182 [55.42]	2.500 [63.50]	2.729 [69.32]	2.157 [54.84]

Dimensions are in inches [mm]

PART NUMBERING

