

# Type B, B/2 Right Angle Female DIN

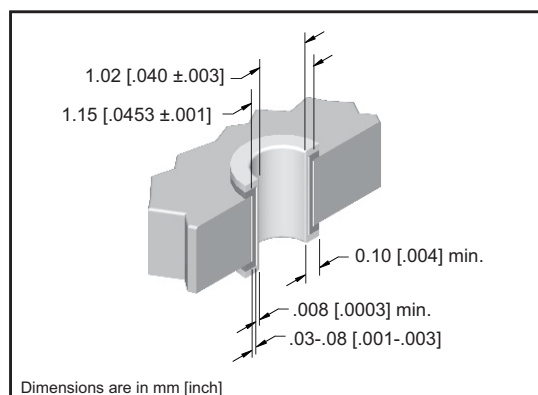

## DIN 41612 SPECIFICATION

Temperature Range	-55°C to +125°C	
Insulator Material	PBT 30% Glass Filled UL 94 V-0 Rated	
Contact Material:	Copper Alloy	
Contact Plating / Performance	Level 1	≥ 500 Mating Cycles
	Level 2	≥ 400 Mating Cycles
Per DIN 41612	Level 3	≥ 50 Mating Cycles
Contact Resistance	≤ 20m Ω	
Insulation Resistance	≥ 10 <sup>12</sup> m Ω at 100 VDC	
Dielectric Strength	≤ 1000 VDC	
Current Range at Ambient Temp. Of	+20C	3.0 Amp
	+70C	2.0 Amp
	+100C	1.0 Amp
Insertion Force (N)	20 contacts @ ≤18      32 contacts @ ≤30 30 contacts @ ≤28      64 contacts @ ≤60	
Withdrawal Forces Per Contact (N)	> .15	



DRILLED HOLE DIAMETER	PLATING THICKNESS	HOLE DIAMETER	PAD DIAMETER		
1.15 [.0453]	Copper .03-.08 [.001-.003] Tin .008 [.0003]min.	After Plating .040±.003	1.65 [.065]		

## APPROVALS



Recognized under the recognized component Program of Underwriters Laboratories, Inc.  
File Numbers: E176234

IEC 60603-2 Standard

## Bellcore GR 1217 CORE

Connectors are available that meet the requirements of Bellcore GR 1217-CORE. Please consult factory for ordering information.

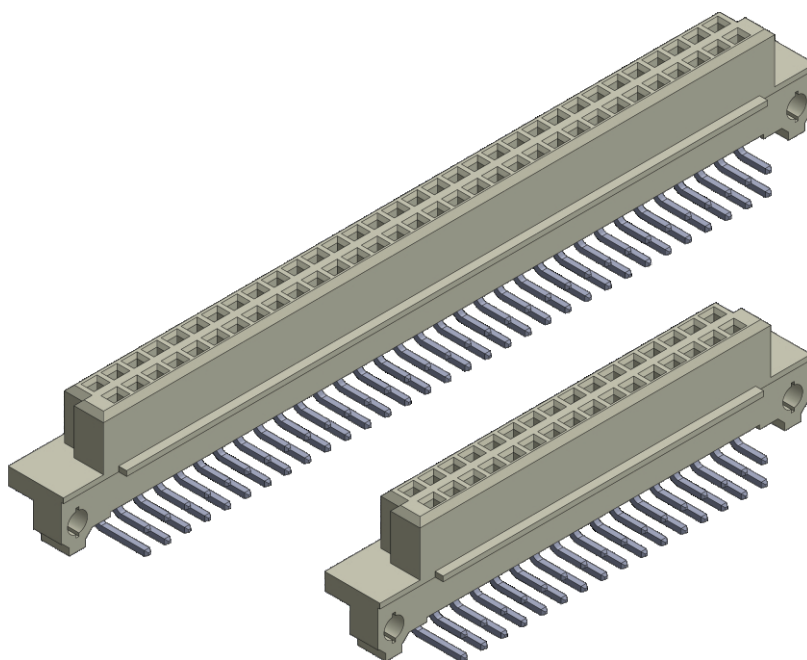

# Type B, B/2 Right Angle Female DIN



Type Q, 64 Positions

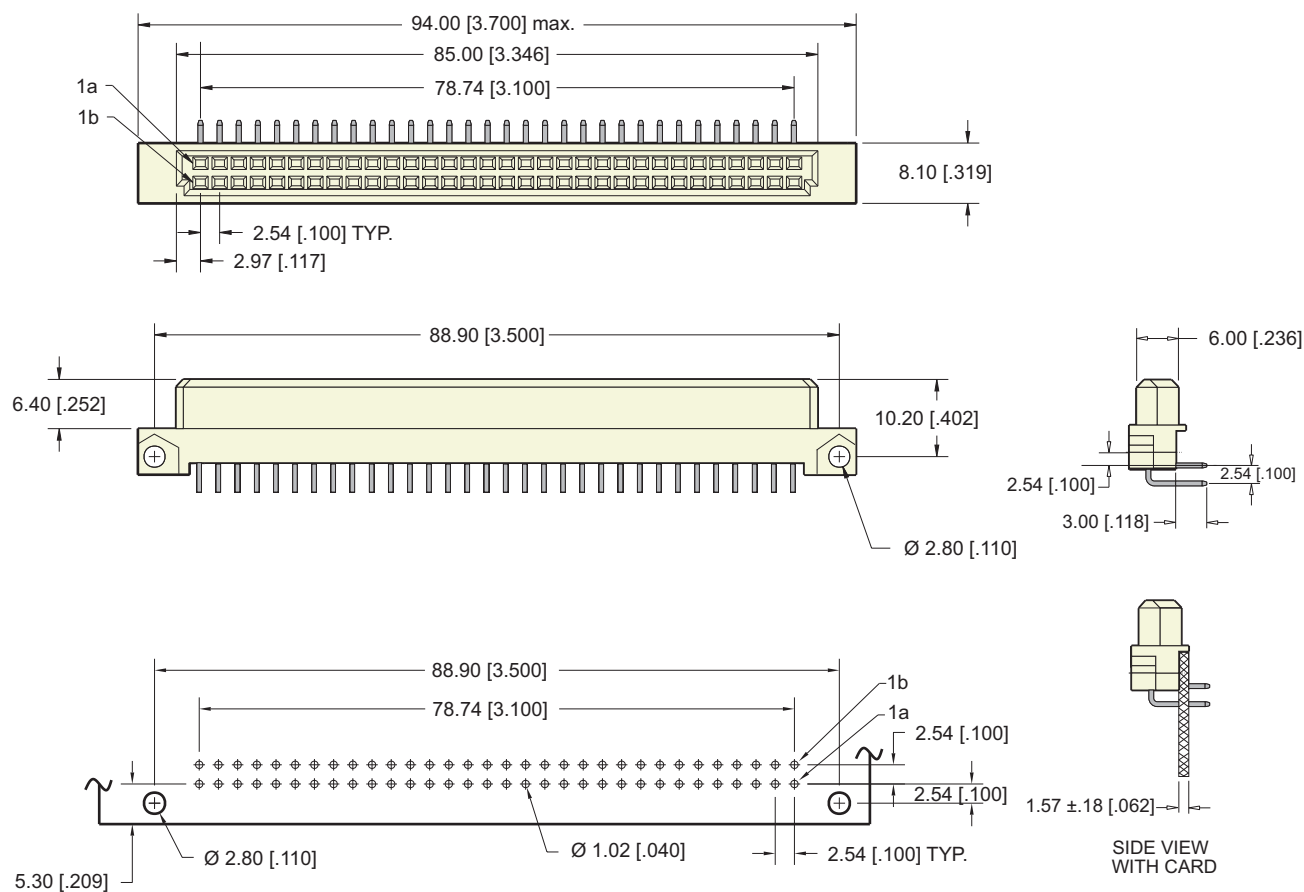

Recommended P. C. Board Layout

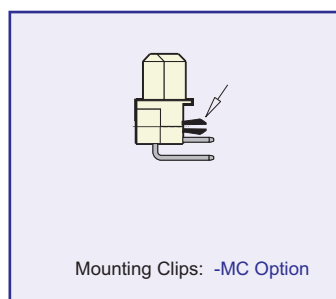
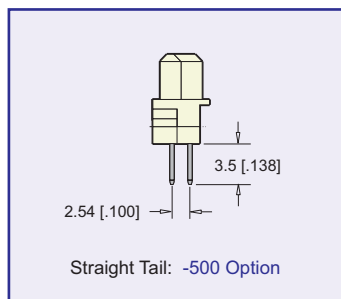

# Type B, B/2 Right Angle Female DIN



Type Q/2, 32 Positions

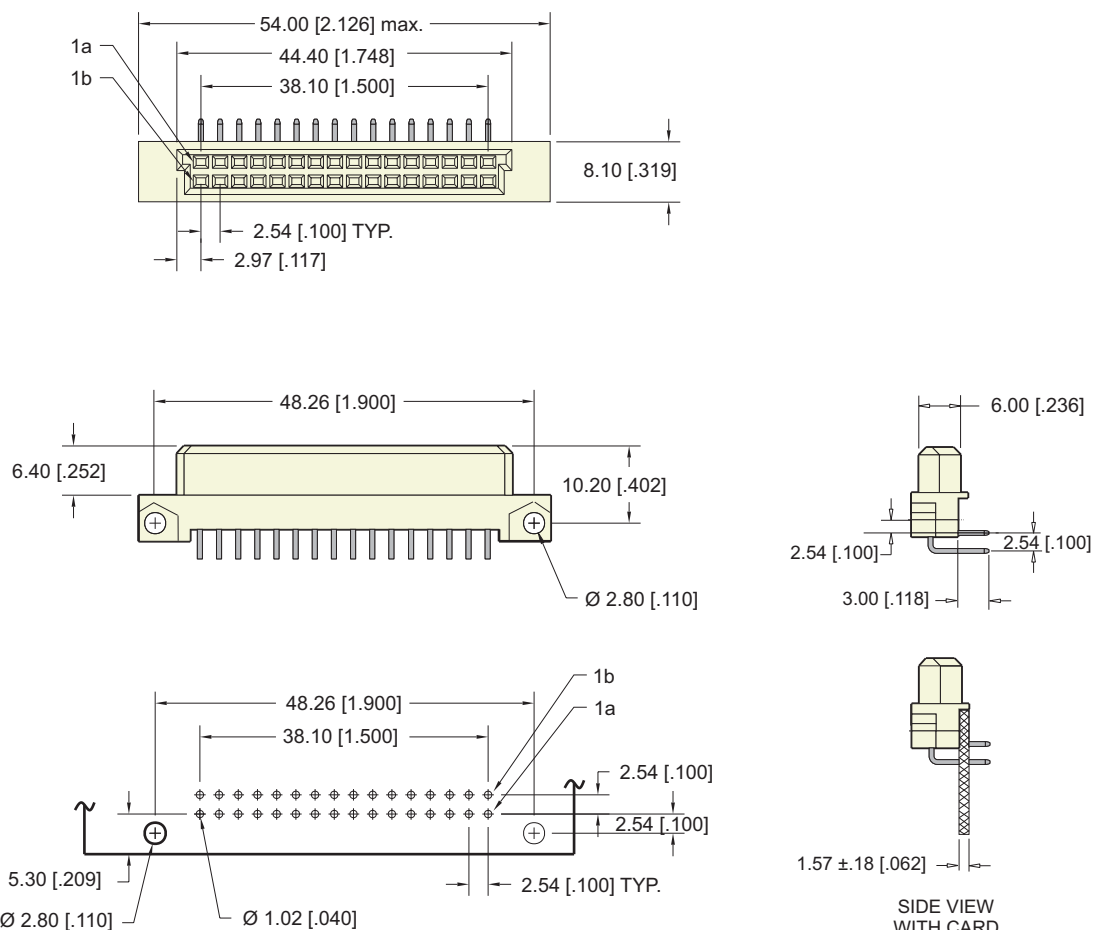

Recommended P. C. Board Layout

## PART NUMBERING

### SERIES CODE

DIN 41612 Female Type Q, Q/2

### BODY STYLE

- 1 = Q/2 (32 positions)
- 2 = Q (64 positions)

### NUMBER OF CONTACTS

- 1 = 16
- 2 = 32
- 3 = 64

### CONTACT LOADING

- 1 = Row A and B fully populated
  - 2 = Row A fully populated, Row B not populated
  - 3 = Row B fully populated, Row A not populated
- Consult Factory for other Loading Options

MC = Mounting Clips  
Blank = No Mounting Clip  
500 = Straight Tail

### TAIL PLATING

1 = Tin

### MATING AREA PLATING

- 1 = Class 1
- 2 = Class 2
- 3 = Class 3