



# 1200 Series Card Edge Connector

## .100" X .200" Contact Spacing, Bellow Contacts

### Specifications

Insulator Material: Glass filled polyester, type PBT, 94 V-O, UL Rated.

Contact Material: Phosphor Bronze Alloy

Contact Plating: Gold and/or Tin over .000050" Nickel, (See Contact Plating Options).

Current Rating: 3 amp at 30°C

Contact Resistance:  
Contact to Daughter Card:  
10 m max.

Insulation Resistance:  
5000 M min.

Dielectric Withstand Voltage:  
1000 V AC

Daughter Board Insertion Force:  
16 oz max. per contact pair  
when tested with a .071" thick  
gage.

Daughter Board Withdrawal Force:  
1 oz min. per contact pair  
when tested with a .054" thick  
gage.

Operating Temperature:  
-54°C to +125°C

### Features

- Extra large chamfered entry
- Conforms to Bell-core spec TR-TSY-00078
- Extended card scoops available
- Replaceable contacts
- Molded in polarization available between contact, or on contact position.
- De-population of contacts per customer specification.
- Available in selective gold plate at contact point
- Many other custom options available, including, but not limited to:
  - Single or Both Ends Open

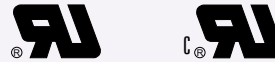

Recognized under the recognized component Program of Underwriters Laboratories, Inc. File Numbers: E146967 and E176234

POS./CONTACTS	A	B	C	D	E	F
08/16	0.700 [17.78]	0.900 [22.86]	1.060 [26.92]	1.375 [34.93]	1.635 [41.53]	0.950 [24.13]
10/20	0.900 [22.86]	1.100 [27.94]	1.260 [32.00]	1.575 [40.00]	1.835 [46.61]	1.150 [29.21]
12/24	1.100 [27.94]	1.300 [33.02]	1.460 [37.08]	1.775 [45.08]	2.035 [51.69]	1.350 [34.29]
15/30	1.400 [35.56]	1.600 [40.64]	1.760 [44.70]	2.075 [52.70]	2.335 [59.31]	1.650 [41.91]
17/34	1.600 [40.64]	1.800 [45.72]	1.960 [49.78]	2.275 [57.79]	2.535 [64.39]	1.850 [46.99]
18/36	1.700 [43.18]	1.900 [48.26]	2.060 [52.32]	2.375 [60.32]	2.635 [66.93]	1.950 [49.53]
20/40	1.900 [48.26]	2.100 [53.34]	2.260 [57.40]	2.575 [65.40]	2.835 [72.01]	2.150 [54.61]
22/44	2.100 [53.34]	2.300 [58.42]	2.460 [62.48]	2.775 [70.48]	3.035 [77.09]	2.350 [59.69]
25/50	2.400 [60.96]	2.600 [66.04]	2.760 [70.10]	3.075 [78.10]	3.335 [84.71]	2.650 [67.31]
28/56	2.700 [68.58]	2.900 [73.66]	3.060 [77.72]	3.375 [85.72]	3.635 [92.33]	2.950 [74.93]
30/60	2.900 [73.66]	3.100 [78.74]	3.260 [82.80]	3.575 [90.80]	3.835 [97.41]	3.150 [80.01]
31/62	3.000 [76.20]	3.200 [81.28]	3.360 [85.34]	3.675 [93.34]	3.935 [99.95]	3.250 [82.55]
35/70	3.400 [86.36]	3.600 [91.44]	3.760 [95.50]	4.075 [103.50]	4.335 [110.11]	3.650 [92.71]
36/72	3.500 [88.90]	3.700 [93.98]	3.860 [98.04]	4.175 [106.04]	4.435 [112.65]	3.750 [95.25]
40/80	3.900 [99.09]	4.100 [104.14]	4.260 [108.20]	4.575 [116.20]	4.835 [122.81]	4.150 [105.41]
43/86	4.200 [106.68]	4.400 [111.76]	4.560 [115.82]	4.875 [123.82]	5.135 [130.43]	4.450 [113.03]
44/88	4.300 [109.22]	4.500 [114.30]	4.660 [118.36]	4.975 [126.36]	5.235 [132.97]	4.550 [115.57]
49/98	4.800 [121.92]	5.000 [127.00]	5.160 [131.06]	5.475 [139.06]	5.735 [145.67]	5.050 [128.27]
50/100	4.900 [124.46]	5.100 [129.54]	5.260 [133.60]	5.575 [141.60]	5.835 [148.21]	5.150 [130.81]
55/100	5.400 [137.16]	5.600 [142.24]	5.760 [146.30]	6.075 [154.30]	6.335 [160.91]	5.650 [143.51]
60/120	5.900 [152.26]	6.100 [154.94]	6.260 [159.00]	6.575 [167.00]	6.835 [173.61]	6.150 [156.21]
61/122	6.000 [152.40]	6.200 [157.48]	6.360 [161.54]	6.675 [169.55]	6.935 [176.15]	6.250 [158.75]
65/130	6.400 [162.56]	6.600 [167.64]	6.760 [171.70]	7.075 [179.70]	7.335 [186.31]	6.650 [168.91]
70/140	6.900 [175.26]	7.100 [180.34]	7.260 [184.40]	7.575 [192.40]	7.835 [199.01]	7.150 [181.61]

Dimensions are in inch [mm]

### MOUNTING STYLE

1 = Clearance Hole	2 = #4-40 Threaded Insert	3 = Flush Mount	4 = #4-40 Threaded Insert	5 = No Mounting Ear	6 = Side Mounting

**.100" x .200" Contact Spacing, Bellow Contacts**

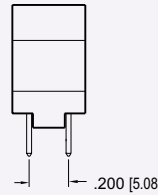
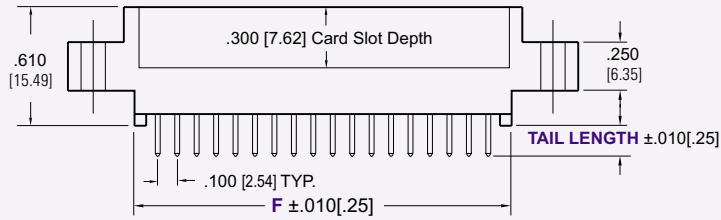
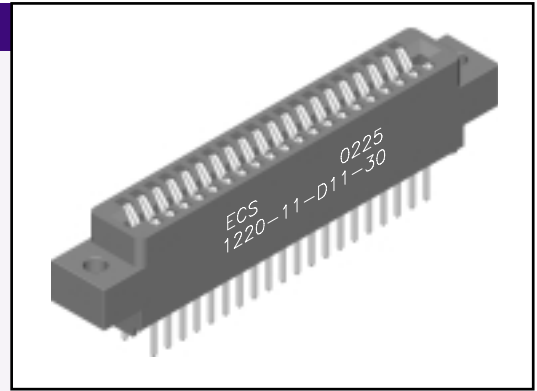
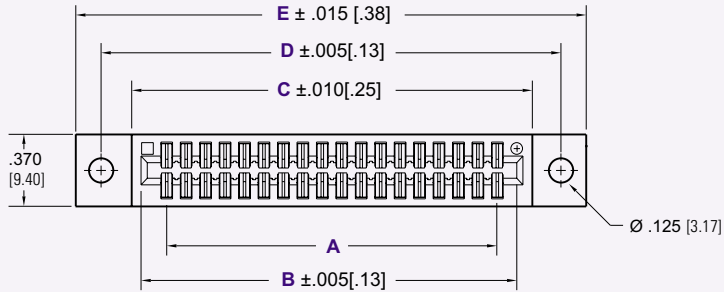

Dimensions are in inch [mm]

**TERMINATION TYPE**

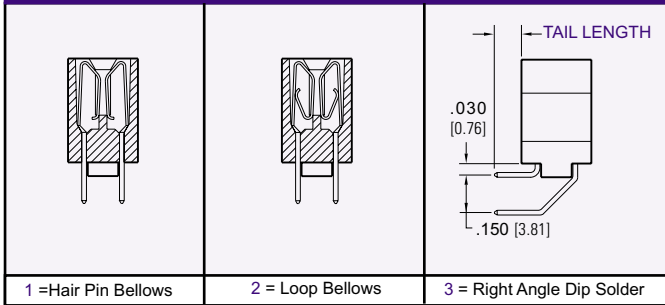

**READOUT**

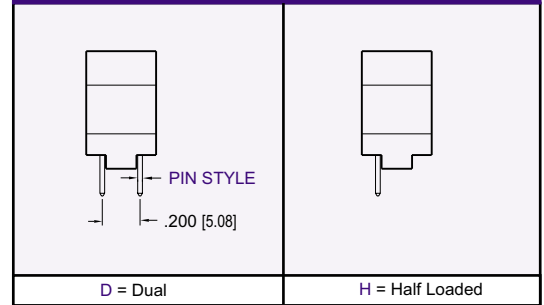

**PART NUMBERING**



**SERIES CODE**

.125" X .250" Dip Solder / Wire Wrap

**NO. CONTACT PAIRS**

01 - 70

**TERMINATION TYPE**

- 1 = Hairpin Bellows
- 2 = Loop Bellows
- 3 = Right Angle Bellows

**MOUNTING STYLE**

- 1 = Clearance Hole
- 2 = #4-40 Threaded Insert
- 3 = Flush Mount
- 4 = Flush Mount / #4-40 Insert
- 5 = No Mounting Ear
- 6 = Side Mounting

**READOUT**

- D = Dual
- H = Half Loaded

**TAIL LENGTH**

- 1 = .190 [4.83] Dip Solder
- 2 = .560 [14.22] Wire VWrap
- 3 = .100 [2.54] Right Angle
- 4 = .180 [4.57] Right Angle
- 5 = .250 [6.35] Right Angle

**PIN STYLE**

- 1 = .025 SQ.
- 2 = .026 DIA.

**CUSTOM VARIATION**  
CONSULT FACTORY

**PLATING**

CONTACT	TAIL
50µ" Nickel Underplate	
10 = 10µ" Au	100µ" Sn
20 = 15µ" Au	100µ" Sn
30 = 30µ" Au	100µ" Sn
40 = 10µ" Au	5µ" Au
50 = 15µ" Au	5µ" Au
60 = 30µ" Au	5µ" Au

CONSULT FACTORY FOR CONNECTORS BUILT TO YOUR SPECIFICATION