



# 1100 Series Card Edge Connector

## .100" X .200" Contact Spacing, ISA Bus

### Specifications

Insulator Material: Glass filled polyester, type PBT, 94 V-O, UL Rated.

Contact Material: Phosphor Bronze Alloy

Contact Plating: Gold and/or Tin over .000050" Nickel, (See Contact Plating Options).

Current Rating: 3 amp at 30°C

Contact Resistance:  
Contact to Daughter Card:  
10 m max.

Insulation Resistance:  
5000 M min.

Dielectric Withstand Voltage:  
1000 V AC

Daughter Board Insertion Force:  
16 oz max. per contact pair when tested with a .071" thick gage.

Daughter Board Withdrawal Force:  
1 oz min. per contact pair when tested with a .054" thick gage.

Operating Temperature:  
-54°C to +125°C

### Features

- Extra large chamfered entry
- Conforms to Bell-core spec TR-TSY-00078
- Extended card scoops available
- Replaceable contacts
- Molded in polarization available between contact, or on contact position.
- De-population of contacts per customer specification.
- Available in selective gold plate at contact point
- Many other custom options available, including, but not limited to:
  - Single or Both Ends Open
  - Shorting Contacts

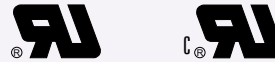

Recognized under the recognized component Program of Underwriters Laboratories, Inc. File Numbers: E146967 and E176234

### READ OUT

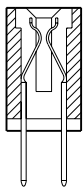

D = Dual Load

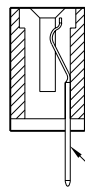

H = Half Load

Even Number Side

### KEY IN BETWEEN CONTACTS (ORDER SEPARATELY)

P/N 11-PK1

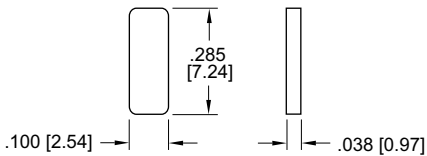

CONSULT FACTORY FOR MOLDED IN KEY

### TERMINATION TYPE

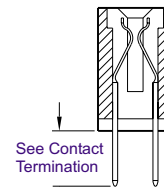

See Contact Termination

1 = STRAIGHT

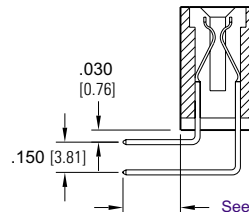

See Contact Termination

2 = RIGHT ANGLE

### MOUNTING STYLE

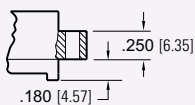

1 = Clearance Hole



2 = #4-40 Threaded Insert

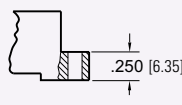

3 = Flush Mount



4 = #4-40 Threaded Insert

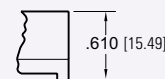

5 = No Mounting Ear



6 = Side Mounting

**.100" x .200" Contact Spacing, ISA Card Edge**

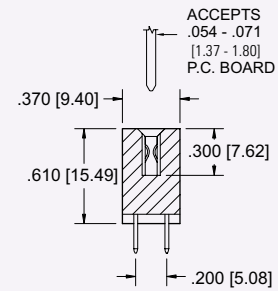
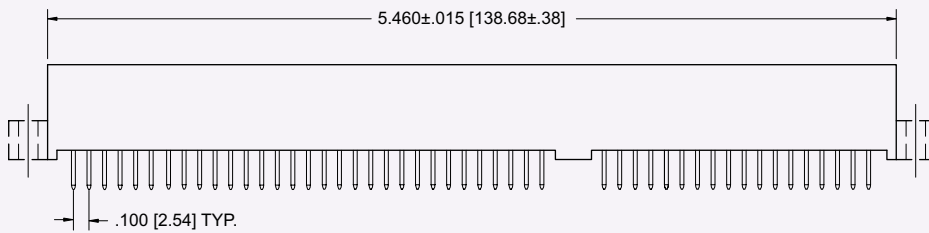
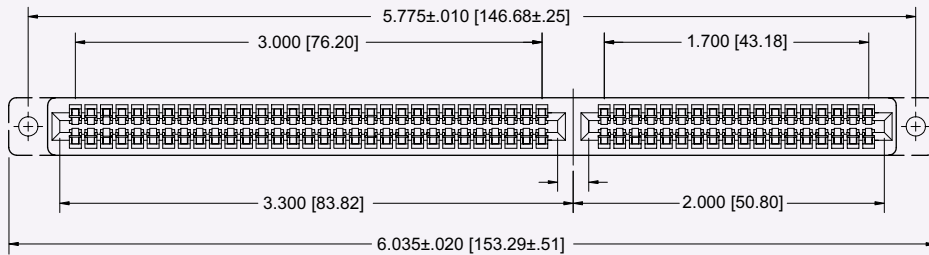
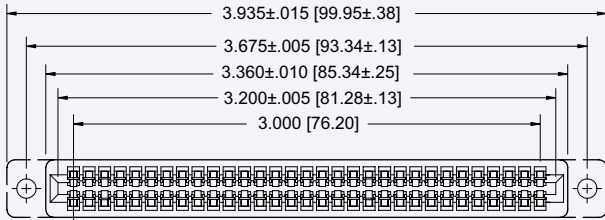
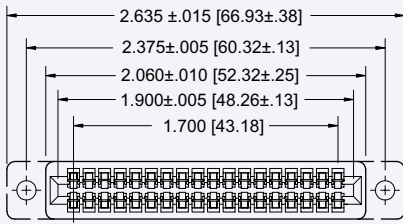
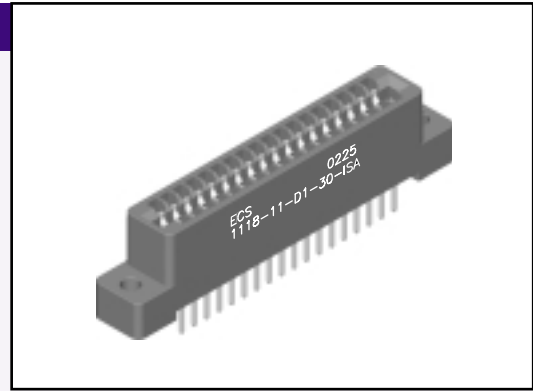

Dimensions are in inch [mm]

**PART NUMBERING**

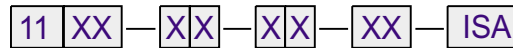

**SERIES CODE**  
.100" x .200" Centers Card Edge ISA Bus

**NO. CONTACT PAIRS**  
18  
31  
49 (18,31)

**TERMINATION TYPE**  
1 = Straight  
2 = Right Angle

**MOUNTING STYLE**  
1 = Clearance Hole  
2 = #4-40 Threaded Insert  
3 = Flush Mount  
4 = Flush Mount / #4-40 Threaded Insert  
5 = No Mounting Ear  
6 = Side Mounting

**CONTACT TERMINATION**  
1 = .190 [4.83] Dip Solder  
2 = .100 [2.54] Dip Solder  
3 = .560 [14.22] Wire Wrap  
4 = .100 [2.54] Right Angle  
5 = .180 [4.57] Right Angle

**READ OUT**  
D = Dual Load  
H = Half Load

**PLATING**  
50µ" Nickel Underplate  
**CONTACT**  
10 = 10µ" Au  
20 = 15µ" Au  
30 = 30µ" Au  
**TAIL**  
100µ" Sn  
100µ" Sn  
100µ" Sn

CONSULT FACTORY FOR CONNECTORS BUILT TO YOUR SPECIFICATION