



2500 Series Card Edge Connector, High Profile SLC 96, .125" X .125" Contact Spacing, Press Fit

Specifications

Insulator Material: Glass filled polyester, type PBT, 94 V-O, UL Rated.

Contact Material: Phosphor Bronze Alloy

Contact Plating: Gold and/or Tin over .000050" Nickel, (See Contact Plating Options).

Current Rating: 3 amps at 30°C

Contact Resistance:
 Contact to Daughter Card:
 10 m max.
 Compliant section to P.T.H.:
 2 m max.

Insulation Resistance:
 5000 M min.

Dielectric Withstand Voltage:
 1500 V AC

Daughter Board Insertion Force:
 16 oz max. per contact pair when tested with a .071" thick gage.

Daughter Board Withdrawal Force:
 1 oz min. per contact pair when tested with a .054" thick gage.

Compliant Section Insertion Force:
 40 lbs max per contact

Compliant Section Withdrawal Force:
 10 lbs min. per contact

Recommended Board Thickness:
 .093"+

Recommended PCB Layout Page A-33

Operating Temperature:
 -54°C to +125°C



Recognized under the recognized component Program of Underwriters Laboratories, Inc.
 File Numbers: E146967 and E176234

Features

- Flat Plate Installation eliminates the need for secondary operation tooling which can damage the connector.
- Extra large chamfered entry
- Conforms to Bell-core spec TR-TSY-00078
- Extended card scoops available
- Replaceable contacts
- Molded in polarization available between contact, or on contact position.
- De-population of contacts per customer specification.
- Available in selective gold plate at contact point
- Many other custom options available, including, but not limited to:
 - Single or Both Ends Open
 - Shorting Contacts

Recommended Hole Size

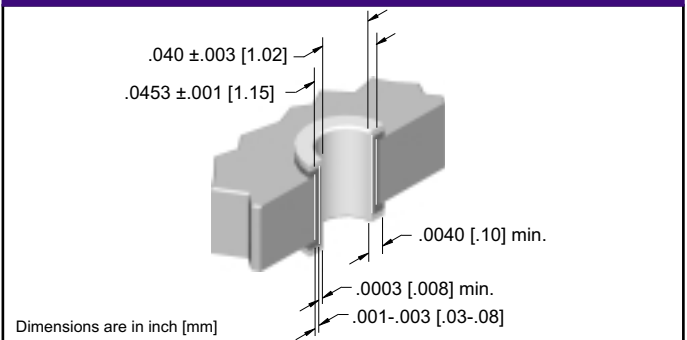

Drilled Hole Diameter	Plating Thickness	Hole Diameter	Pad Diameter
.0453±.001 [1.15]	Copper .001-.003 [.03-.08]	After Plating .040±.003 [1.02]	.065 [1.65]
	Tin / Lead .0003 [.008]min.		

NO. OF POS./CONTACTS	A	B	C
25/50	3.400 [86.34]	3.230 [82.04]	3.000 [76.20]
27/54	3.650 [92.71]	3.480 [88.39]	3.250 [82.55]
30/60	4.025 [102.24]	3.855 [97.92]	3.625 [92.08]
50/100	6.525 [165.74]	6.355 [161.42]	6.125 [155.58]

For reference only, can go 1 through 50 positions.

Dimensions are in inch [mm]

.125" x .125" Contact Spacing, High Profile

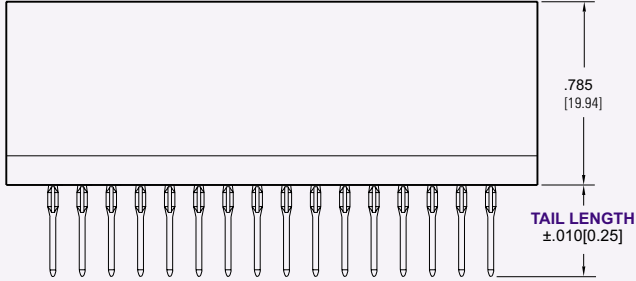
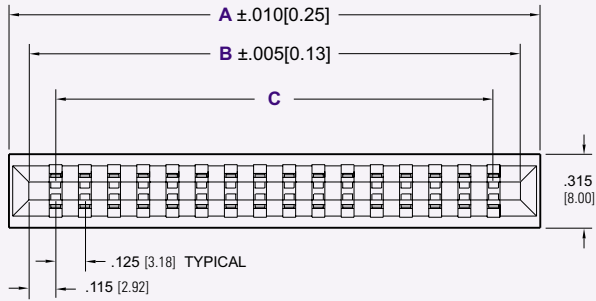

ACCEPTS .054 - .071 [1.37 - 1.80] P.C. BOARD

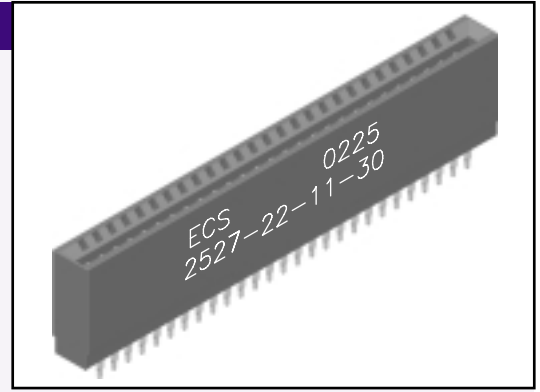
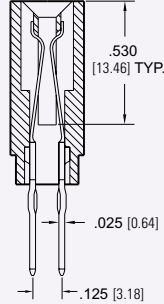

Dimensions are in inch [mm]

CONTACT STYLE

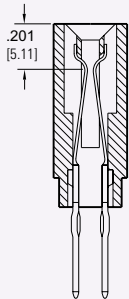

1 = EARLY MAKE CONTACTS

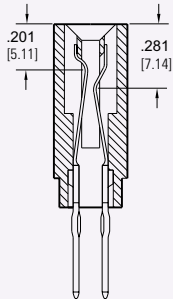

2 = EARLY / LATE MAKE CONTACTS

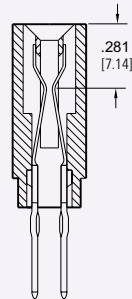

3 = LATE MAKE CONTACTS

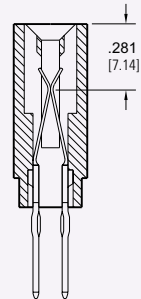

SHORTING CONTACTS

PART NUMBERING

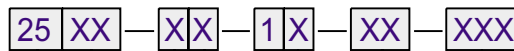

SERIES CODE
 .125" X .125" Centers, SLC High Profile

NO. CONTACT PAIRS
 01 - 50

CONTACT STYLE
 1 = Early Make Contacts
 2 = Early/Late Make Contacts
 3 = Late Make Contacts

SHORTING CONTACTS
 1 = Without
 2 = With

CUSTOM VARIATION
 CONSULT FACTORY

TAIL LENGTH
 1 = .180 [4.57]
 2 = .634 [16.10]

PLATING
 50µm Nickel Underplate

CONTACT	TAIL
10 = 10µm Au	100µm Sn
20 = 15µm Au	100µm Sn
30 = 30µm Au	100µm Sn
40 = 10µm Au	5µm Au
50 = 15µm Au	5µm Au
60 = 30µm Au	5µm Au

CONSULT FACTORY FOR CONNECTORS BUILT TO YOUR SPECIFICATION