



DIN 41612

Type R, R/2 and R Extended Female Connectors

Type R (96 Positions), R Extended (120 Positions)

Dim.	96 Positions	120 Positions
A	78.74 [3.100]	99.06 [3.900]
B	85.00 [3.346]	105.21 [4.142]
C	94.00 [3.700]	114.20 [4.496]
D	88.90 [3.500]	109.22 [4.300]

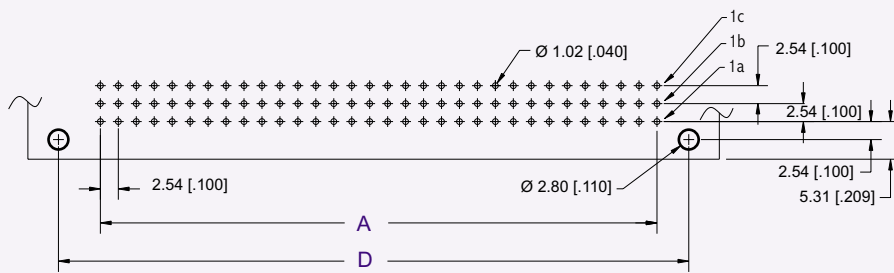
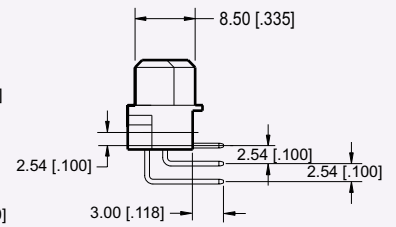
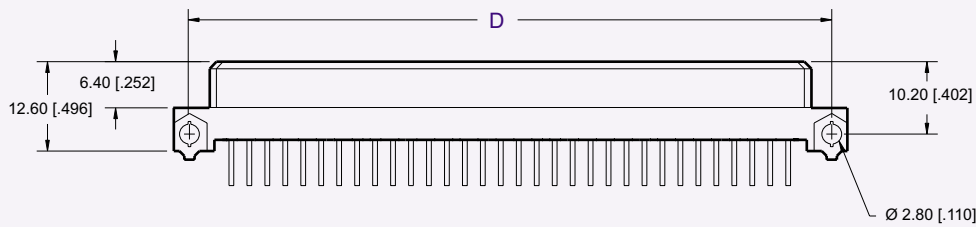
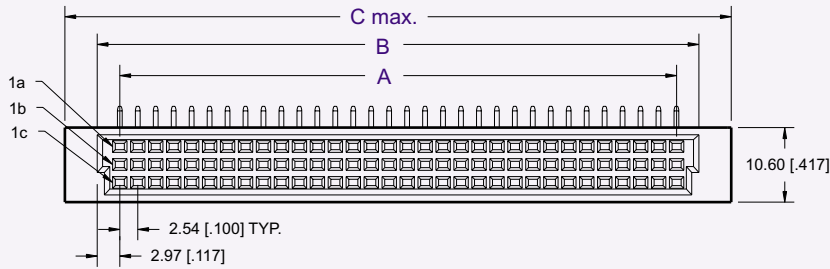

Recommended P. C. Board Layout

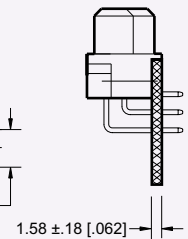

SIDE VIEW WITH CARD

Dimensions are in mm [inches]

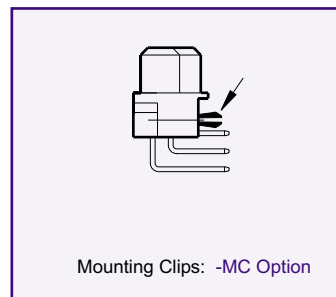
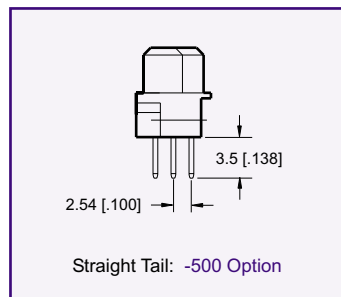

Type R/2, 48 Positions

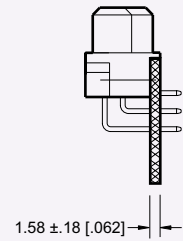
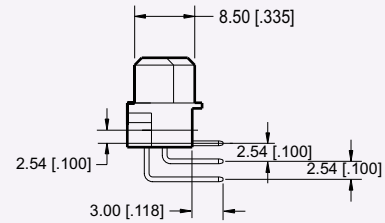
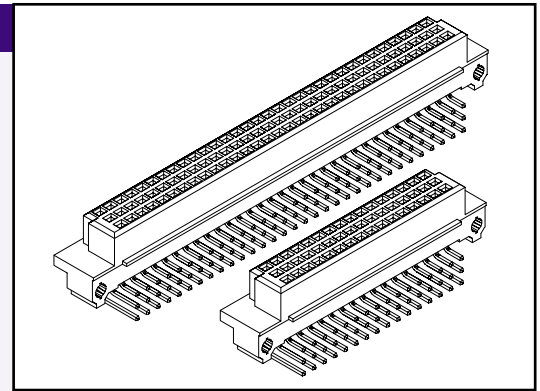
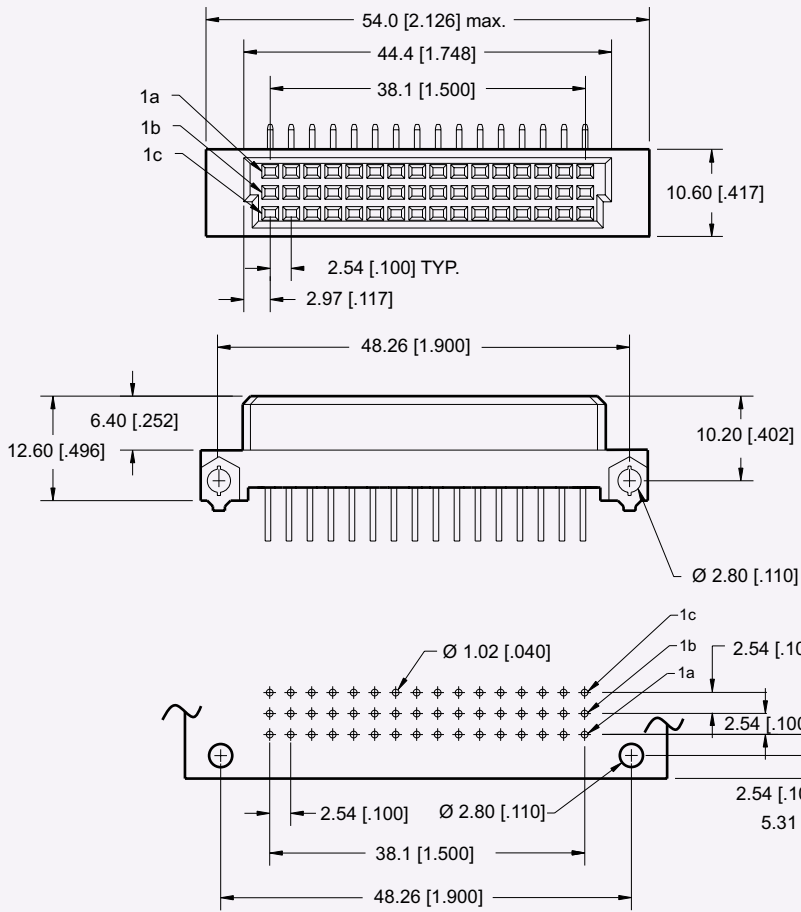

SIDE VIEW WITH CARD

Recommended P. C. Board Layout

Dimensions are in mm [inches]

PART NUMBERING

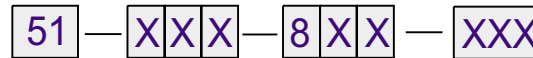

SERIES CODE

DIN 41612 Type R, R/2, R Extended Female

BODY STYLE

- 1 = R/2 (48 positions)
- 2 = R (96 positions)
- 4 = R Extended (120 positions)

NUMBER OF CONTACTS

- 1 = 16
- 2 = 32
- 3 = 48
- 4 = 64
- 5 = 96
- 7 = 120

CONTACT LOADING

- 1 = Row A, B, and C fully populated
 - 2 = Row A and B fully populated, Row C not populated
 - 3 = Row A and C fully populated, Row B not populated
 - 4 = Row B and C fully populated, Row A not populated
- Consult Factory for other Loading Options

- Blank = No Mounting Clip
- MC = Mounting Clip
- 500 = Straight Tail

TAIL PLATING

- 1 = Tin Lead

MATING AREA PLATING

- 1 = Class 1
- 2 = Class 2
- 3 = Class 3

CONSULT FACTORY FOR CONNECTORS BUILT TO YOUR DESIGN